

DECALU 88 NEW STEEL



deceuninck

Parameters of DECALU 88 NEW STEEL

- installation depth **88 mm**,
- max. glass thickness **62 mm**,
- U_w from **0,7 W/m²*K**,
- combination with the movable post **110 mm**,
- frame and sash combination **83 mm**.

DECALU 88 NEW STEEL of SO EASY technology enables the production of windows with an appearance of characteristic steel frames. The subtle, additional visual line around the profiles highlights the outline of the window from the outside. DECALU 88 NEW STEEL windows are the best example of unmatched beauty and elegance of aluminium structures. Modern and renovated buildings, facades made of modern materials or horizontal wooden boards are a perfect match for structures made in SO EASY technology.

DECALU 88 NEW STEEL

If you choose **DECALU 88 NEW STEEL** made in the **SO EASY** technology, you will obtain:

- highly energy-efficient windows,
- the best parameters of air permeability in class 4,
- high water-tightness parameters up to 2250Pa,
- the most daylight into interiors,
- easy cleaning, without a central gasket,
- no local corrosion at the interface between the profiles and the fitting hidden hinges,
- machine integration of gaskets with profiles,
- the highest level of functionality and aesthetics,
- wide visual range of products based on the SO EASY technology.



HORIZONTAL SECTION

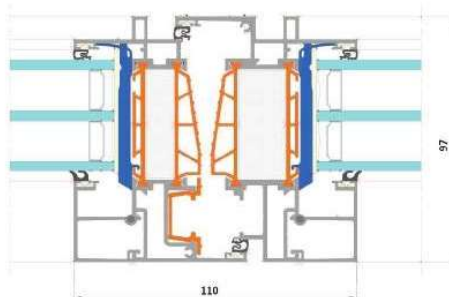

VERICAL SECTION

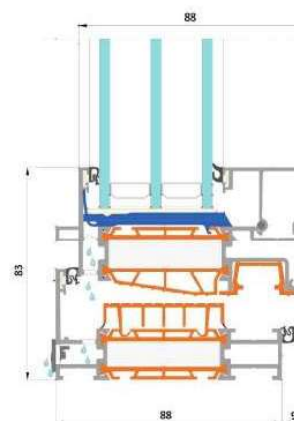

	Air permeability	Watertightness	Resistance to wind load	Operational forces	Mechanical strenght
DECALU 88 NEW STEEL	Class 4	Class E2250 (2250Pa)	Class C5 / B5	Class 1	Class 4
Norms	PN - EN 12207:2017	PN - EN 12208:2001	PN - EN 12210:2016	PN - EN 13115:2002	PN - EN 13049:2004